

310 INTERLOCKEN
310 INTERLOCKEN PARKWAY, BROOMFIELD, CO

FOR MORE INFO PLEASE CALL

(303) 447 2700



Exclusively presented by :

Keys Commercial

RARE INTERLOCKEN

LEASE OPPORTUNITY

FOR LEASE

PROPERTY FEATURES

- ✔ Flexible Suite Sizes
- ✔ On Site Parking
- ✔ Year Built : 1986
- ✔ Min. Divisible: 8000 SF
- ✔ Base Rent \$14/SF NNN
- ✔ Opex: \$8.19/SF



ABOUT PROPERTY

In the heart of Interlocken Business Park, halfway between Boulder and Denver. Interlocken Business Park has quick and easy access to US-36 and CO-128, connecting to CO-93 providing quick access for any number of commutes.

Geoffrey E. Keys - President
Ronan B. Truesdale- Vice President
George G. Ryan - Broker Associate

📍 1048 Pearl St Suite 440 , Boulder , CO
✉ info@keys-commercial.com
🌐 www.keys-commercial.com

310 INTERLOCKEN
310 INTERLOCKEN PARKWAY, BROOMFIELD, CO

FOR MORE INFO PLEASE CALL
(303) 447 2700



Exclusively presented by :

Keys Commercial

RARE INTERLOCKEN

LEASE OPPORTUNITY

FOR LEASE

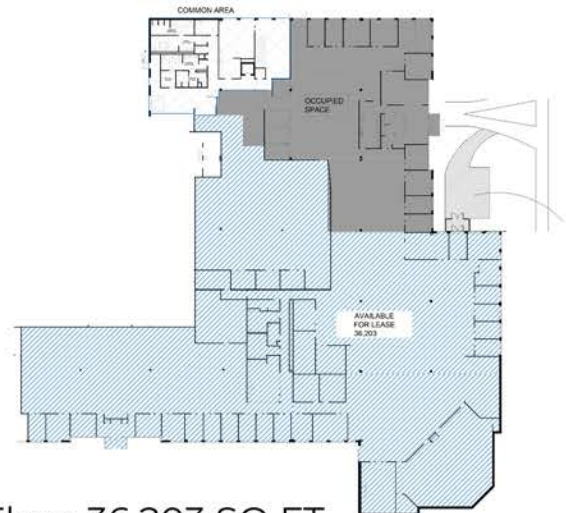

First Floor 36,203 SQ FT

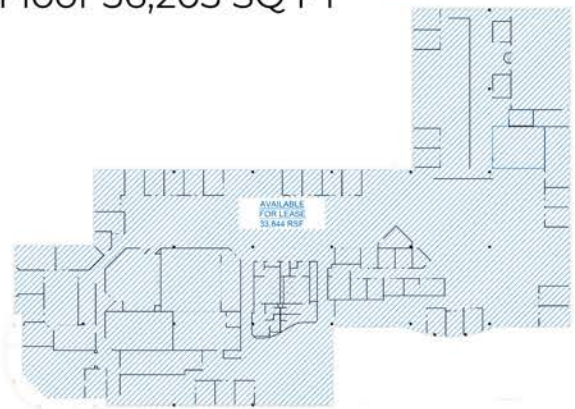

Second Floor 33,844 SQ FT

Geoffrey E. Keys - President
Ronan B. Truesdale - Vice President
George G. Ryan - Broker Associate

📍 1048 Pearl St Suite 440 , Boulder , CO
✉ info@keys-commercial.com
🌐 www.keys-commercial.com